

ADJOINING PROPERTIES IMPROVED PRIOR TO OCT. 11, 1955.

NASSAU COUNTY TEST WELL NO. N-09656
 MAX. GROUND WATER EL. 35.99 7/17/48
 SAFETY FACTOR 1.5
 MIN. BSMT. FLOOR EL. 37.5

SURVEY & TREE PRESERVATION SURVEY
 TBR DENOTES TO BE REMOVED

ELEVATIONS SHOWN HEREON ARE IN NASSAU COUNTY AND U.S. COAST AND GEODETIC SURVEY VERTICAL DATUM.

ISSUING OF A NEW TITLE POLICY OR REDATING OF AN EXISTING POLICY REFERENCING THIS SURVEY WITHOUT BENEFIT OF AN UPDATE OF THIS SURVEY BY VITO A. VALENTI, LAND SURVEYOR SHALL TERMINATE ANY LIABILITY EXPRESSED OR IMPLIED HEREON.

THE EXISTENCE OF RIGHTS OF WAY AND/OR EASEMENTS OF RECORD, IF ANY, NOT SHOWN ARE NOT CERTIFIED.

UNAUTHORIZED ALTERATION OR ADDITION TO THIS SURVEY IS A VIOLATION OF SECTION 7209 OF THE NEW YORK STATE EDUCATION LAW. COPIES OF THIS SURVEY MAP NOT BEARING THE LAND SURVEYOR'S INKED SEAL OR EMBOSSED SEAL SHALL NOT BE CONSIDERED TO BE A VALID TRUE COPY. CERTIFICATIONS INDICATED HEREON SHALL RUN ONLY TO THE PERSON FOR WHOM THE SURVEY IS PREPARED, AND ON HIS BEHALF TO THE TITLE COMPANY, GOVERNMENTAL AGENCY AND LENDING INSTITUTION LISTED HEREON, AND TO THE ASSIGNEES OF THE LENDING INSTITUTION. CERTIFICATIONS ARE NOT TRANSFERABLE TO ADDITIONAL INSTITUTIONS OR SUBSEQUENT OWNERS.

VITO A. VALENTI
 LAND SURVEYOR

732 MAIN STREET, FARMINGDALE, NEW YORK 11735
 (516) 249-6363 FAX (516) 249-6364

SCALE: 1" = 20' © 2004

SURVEY OF: LOTS 126-128
 FILED MAP: OAKDALE PARK
 FILED JUNE 11, 1925 NO. 549
 LOCATED AT: BELLMORE - NASSAU COUNTY, N.Y.
 TAX DESIG.: SEC. 51; BLK. 71; LOTS 126-128

CERTIFIED TO: CUSTOM VILLAGE PARAGON ABSTRACT, INC.
 TITLE NO.:
 DATE: JULY 16, 2004
 BY: *Vito A. Valenti*

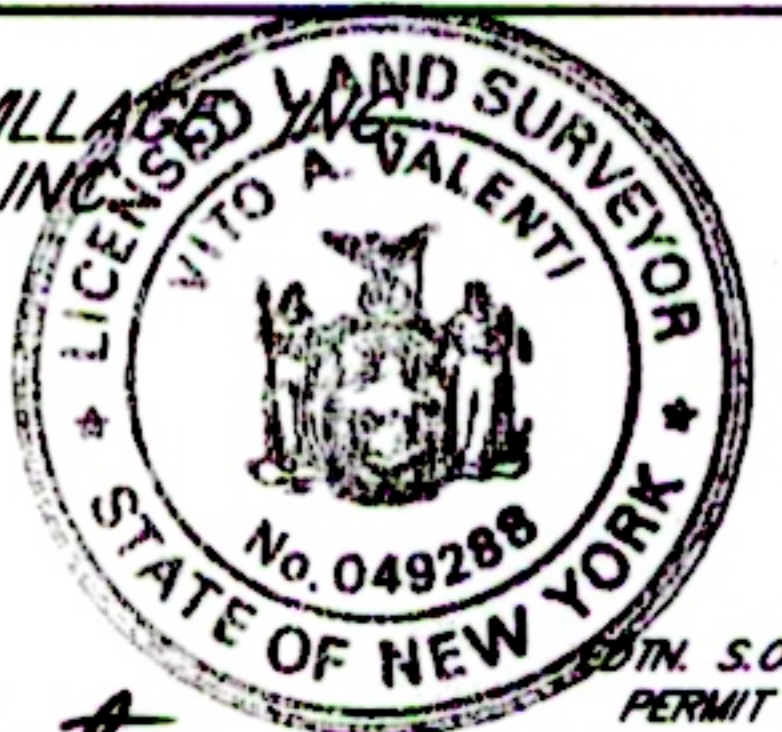

EDM. S.O. 7/8/04
 PERMIT 5/23/05