

NASSAU COUNTY TEST WELL N-01184
 MAXIMUM GROUND WATER EL. 24.30 7/17/48
 SAFETY FACTOR 1.50
 MINIMUM BSMT. FLOOR EL. 25.80

ELEVATIONS SHOWN HEREON ARE IN NASSAU COUNTY AND NATIONAL GEODETIC VERTICAL DATUM.

ISSUING OF A NEW TITLE POLICY OR REDATING OF AN EXISTING POLICY REFERENCING THIS SURVEY WITHOUT BENEFIT OF AN UPDATE OF THIS SURVEY BY VITO A. VALENTI, LAND SURVEYOR SHALL TERMINATE ANY LIABILITY EXPRESSED OR IMPLIED HEREON.

THE OFFSETS OR DIMENSIONS SHOWN FROM THE STRUCTURES TO THE PROPERTY LINES ARE FOR A SPECIFIC PURPOSE AND USE AND THEREFORE ARE NOT INTENDED TO GUIDE THE ERECTION OF FENCES, RETAINING WALLS, POOLS, PATIOS, PLANTING AREAS, ADDITION TO STRUCTURES AND ANY OTHER CONSTRUCTION.

THE EXISTENCE OF RIGHTS OF WAY AND/OR EASEMENTS OF RECORD, IF ANY, NOT SHOWN ARE NOT CERTIFIED.

UNAUTHORIZED ALTERATION OR ADDITION TO THIS SURVEY IS A VIOLATION OF SECTION 7209 OF THE NEW YORK STATE EDUCATION LAW. COPIES OF THIS SURVEY MAP NOT BEARING THE LAND SURVEYOR'S INKED SEAL OR EMBOSSED SEAL SHALL NOT BE CONSIDERED TO BE A VALID TRUE COPY. CERTIFICATIONS INDICATED HEREON SHALL RUN ONLY TO THE PERSON FOR WHOM THE SURVEY IS PREPARED, AND ON HIS BEHALF TO THE TITLE COMPANY, GOVERNMENTAL AGENCY AND LENDING INSTITUTION LISTED HEREON, AND TO THE ASSIGNEES OF THE LENDING INSTITUTION. CERTIFICATIONS ARE NOT TRANSFERABLE TO ADDITIONAL INSTITUTIONS OR SUBSEQUENT OWNERS.

VITO A. VALENTI
 LAND SURVEYOR

732 MAIN STREET, FARMINGDALE, NEW YORK 11735
 (516) 249-6363 FAX (516) 249-6364

SCALE: 1" = 20' © 2006

SURVEY OF: LOT 1194 & P/O LOTS 1193 & 1195
 FILED MAP: MERRICK MANOR ADDITION
 FILED OCT. 3, 1904 NO. 1904
 LOCATED AT: MERRICK - NASSAU COUNTY, NY
 TAX DESIG.: SEC. 56; BLK. 23; LOT 1194, 1272 & P/O LOT 1193

CERTIFIED TO:

TITLE NO.:

DATE: JUNE 4, 2006

BY: *Vito A. Valenti*

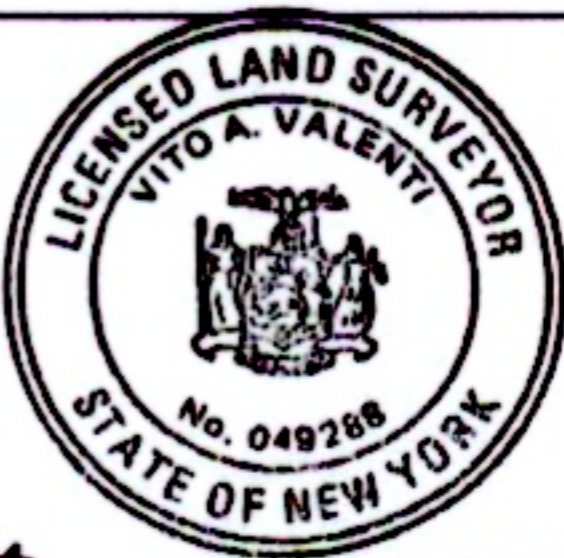

JOB NO. 56-23-1189, 1